



## EC type-examination certificate

**Certificate no.:** AFV 203/6  
**Notified body:** TÜV SÜD Industrie Service GmbH  
 Zertifizierungsstelle für Aufzüge und Sicherheitsbauteile  
 Westendstrasse 199  
 D-80686 München  
**Applicant/  
 Certificate holder:** Inventio AG  
 Seestrasse 55  
 CH-6052 Hergiswil  
**Date of submission:** 2008-06-03  
**Accredited manufacturer  
 of the holding:** Schindler Drive Systems  
 Poligono „Empresarium“  
 Albardin, 58  
 ES-50720 La Cartuja Baja – Zaragoza  
 Elevadores Atlas Schindler S. A.  
 R. Angelina Ricci Vezozzo, 3400  
 BR-86087 – Londrina – PR  
**Product:** Instantaneous safety gear  
**Type:** SA RF 1  
**Test laboratory:** TÜV SÜD Industrie Service GmbH  
 Abteilung Aufzüge und Sicherheitsbauteile  
 Westendstrasse 199  
 D-80686 München  
**Date and number  
 of test report:** 2009-03-30  
 203/6  
**EC-Directive:** 95 / 16 / EC  
**Statement:** The safety component conforms to the directive's essential  
 safety requirements for the respective scope of application  
 stated on page 1 of the annex to this EC type-examination  
 certificate  
**Certificate date:** 2009-03-31

Zertifizierungsstelle für Aufzüge und Sicherheitsbauteile  
 EC-Identification number: 0036

*S. Melzer*

Siegfried Melzer





**Annex to the EC type-examination certificate  
no. AFV 203/6 dated 2009-03-31**

**1. Scope of Application**

- 1.1 Permissible total mass of car and rated load or counterweight in using one pair of safety gears, depends on maximum tripping speed of the overspeed governor and the blade width of guide rails

Tripping speed (m/s)	Maximum total mass (kg)		
	Blade width 8 mm	Blade width 9 mm	Blade width 10 - 16 mm
0,50	3890	4053	4943
0,60	3743	3900	4756
0,70	3583	3733	4553
0,80	3414	3558	4339
0,90	3241	3378	4119
1,00	3068	3197	3899
1,10	2897	3018	3681
1,20	2730	2844	3469
1,32	2530	2645	3226
1,40	2415	2516	3069
1,55	2200	2293	2796
1,65	2067	2154	2626

1.2 Maximum rated speed

- 1.2.1 Car 0,63 m/s  
1.2.2 Counterweight 1,00 m/s

1.3 Maximum tripping speed of overspeed governor

- 1.3.1 Car 1,00 m/s  
1.3.2 Counterweight 1,65 m/s

- 1.4 Minimum running surface width of guide rails 27 mm

**2. Remarks**

- 2.1 The test over covers the safety gear and the safety gear elements (rollers) and did not include either the connection between the individual safety gear elements (safety gear rods) or the actuation of the electric safety device. When connecting the safety gear elements to the overspeed governor, attention must be paid to the fact that, at the point at which the overspeed governor rope engages, the car don't travel more than 0,03 m until the safety gear element engage.
- 2.2 In order to provide identification and information about the basic design and its functioning, drawing No. M\_\_ 41314560 with revision state Ae0 is to be enclosed with the EC type-examination certificate and the Annex thereto. The environmental conditions and connection requirements of the safety gear are presented or described in separate document (e. g. installation instructions).
- 2.3 The EC type-examination certificate may only be used in connection with the pertinent annex.

Cet ouvrage est notre propriété intellectuelle. Sans notre autorisation écrite, il ne peut être ni copié d'une manière quelconque, ni être utilisé pour la fabrication, ni non plus être communiqué à des tiers.

Diese Darstellung ist unser geistiges Eigentum. Sie darf ohne unsere schriftliche Zustimmung weder irgendwie kopiert noch zur Anfertigung des Werkes gebraucht oder Dritten bekanntgegeben werden.

This presentation is our intellectual property. Without our written consent, it shall neither be copied in any manner, nor used for manufacturing, nor communicate to third parties.

Pro/E.

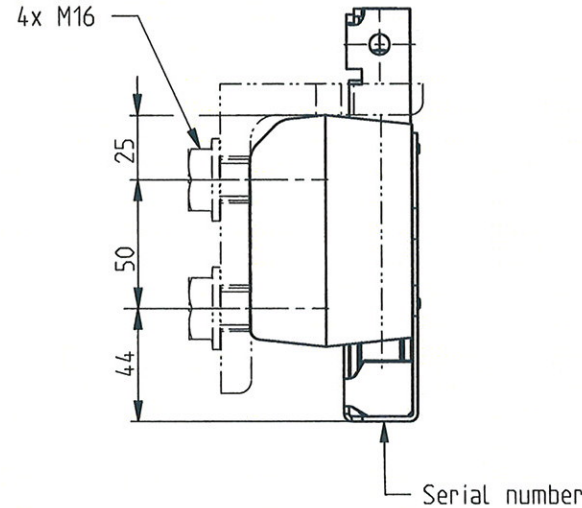
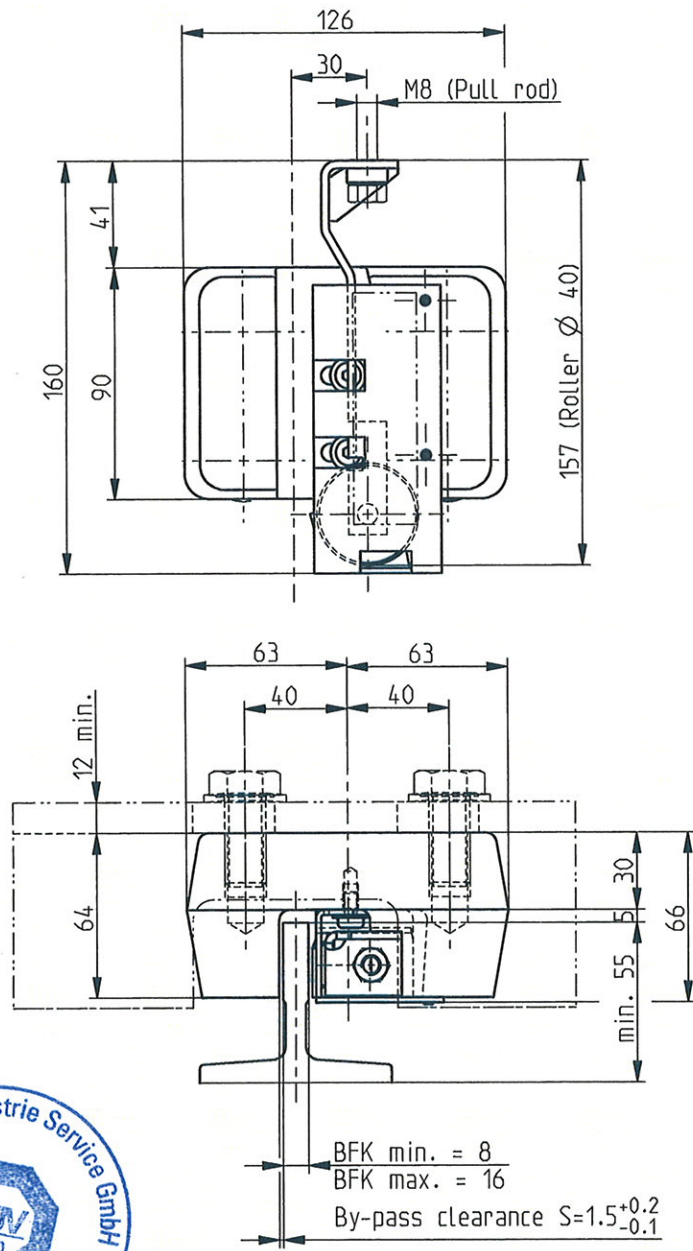

3 1. März 2009

**- GEPRÜFT -**  
 TÜV SÜD Industrie Service GmbH  
 Zentralbereich Fördertechnik-Sonderbauten  
 Abteilung Aufzüge und Sicherheitsbauteile  
 Westendstr. 199, D-80686 München  
 Der Sachverständige

Notes:

- SA RF 1 works only in down direction

59314560									4.797
Ident. No.	Semi finished product / raw material	Semi fin. Ident. No.	Item	Code surface	Heat treatment	Drawg / BOH / Model	Weight		
Modification				Ae0	Draw Ver.	Related BOH			
KA No.				158190	7	Related BOH			
KA Date				2009-05-15	Model Ver.	Related BOH			
					5	Release Level		Released	
Group: SAFETY				Remark			Date	Name	
Dimensioned Drawing SA RF 1				Scale	Replaces / Ae:	Prepared	2009-03-18	draeyere	
SA RF 1				1:2	Z 315573 / Ae4	Reviewed	2009-03-18	Legerebe	
				Page	Norms checked	Released	2009-03-18	Legerebe	
				1/1				fischlma	
INVENTIO AG CH-6052 Hergiswil			Classification	Lead Office	M__41314560			Lang.	
			11540	EB3				EN	
			Format A3						