



EC type-examination certificate

Certificate no.:	AFV 365/4
Notified body:	TÜV SÜD Industrie Service GmbH Westendstr. 199 80686 München - Germany
Applicant/ Certificate holder:	Inventio AG Seestrasse 55 6052 Hergiswil – Switzerland
Date of application:	2010-09-23
Manufacturer of the test sample:	Schindler Drive Systems Poligono "Empresarium" Albardin, 58 50720 La Cartuja Baja – Zaragoza – Spain
Product:	Progressive safety gear
Type:	SA G 21
Test laboratory:	TÜV SÜD Industrie Service GmbH Prüflaboratorium für Produkte der Fördertechnik Prüfbereich Aufzüge und Sicherheitsbauteile Westendstr. 199 80686 München - Germany
Date and number of the test report:	2010-10-26 AFV 365/4
EC-Directive:	95 / 16 / EC
Result:	The safety component conforms to the essential safety requirements of the Directive for the respective scope of application stated on page 1 of the annex to this EC type-examination certificate.
Date of issue:	2010-10-28

Certification body for lifts and safety components
Identification number: 0036

C. Rührmeyer
Christian Rührmeyer



**Annex to the EC type-examination certificate
no. AFV 365/4 dated 2010-10-28**

1 Scope of Application

- 1.1 Permissible total mass of car and rated load or counterweight in using one pair of safety gears, depends on maximum tripping speed of overspeed governor and the condition of the guide rail running surface

Max. tripping speed (m/s)	Condition of the running surface	Total mass (kg) min. - max.
3.00	dry or oiled*	5500 - 17000
3.30	dry or oiled*	5500 - 15000
9.60	dry	4800 - 11700

*HLP-oils according to DIN 51524, part 2 or oils with comparable characteristics

The total mass corresponding of the intermediate values of the maximum tripping speed can be determined through linear interpolation.

- 1.2 Maximum tripping speed of overspeed governor and range of the maximum rated speed

Maximum tripping speed (m/s)	3.0	3.3	9.6
Range of the maximum rated speed (m/s)	2.40 – 2.61	2.64 – 2.87	7.68 – 8.35

- 1.3 Guide rails to be used

1.3.1 Running surface manufactured by machined

1.3.2 Minimum running surface width 42 mm

1.3.3 Blade width 15.88 – 28.60 mm

2 Remarks

- 2.1 Pursuant to the standard EN 81, annex F, paragraph 3, section 3.4.a) 2) the total mass determined for adjustment purposes may be 7,5 % higher or lower.
- 2.2 In order to provide identification and information about the basic design and it's functioning and to show which parts have been tested of the approved type drawing no. M__ 103721 with revision state Ae0 is to be enclosed with the EC type-examination certificate and the annex thereto. The environmental conditions and connection requirements of the safety gear are presented or described in separate documents (e. g. installation instructions).
- 2.3 The EC type-examination certificate may only be used in connection with the pertinent annex and the list of the authorized manufacturers (according to enclosure). This enclosure shall be updated and re-edited following information of the certificate holder.



Industrie Service

**Enclosure of EC type - examination certificate
No. AFV 365/4 dated 2010-10-28**

Authorised manufacturer – Production sites (Stated: 2010-10-28):

Schindler Drive Systems
Poligono "Empresarium"
Albardin, 58
50720 La Cartuja Baja – Zaragoza – Spain

- END OF DOCUMENT -

Base: Letter of Schindler Elevator Ltd. dated 2010-09-23

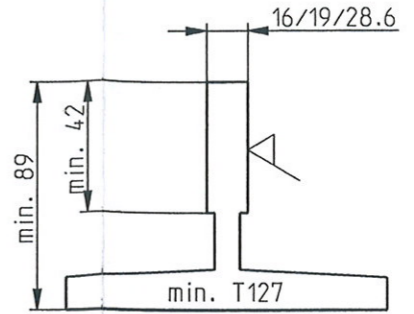
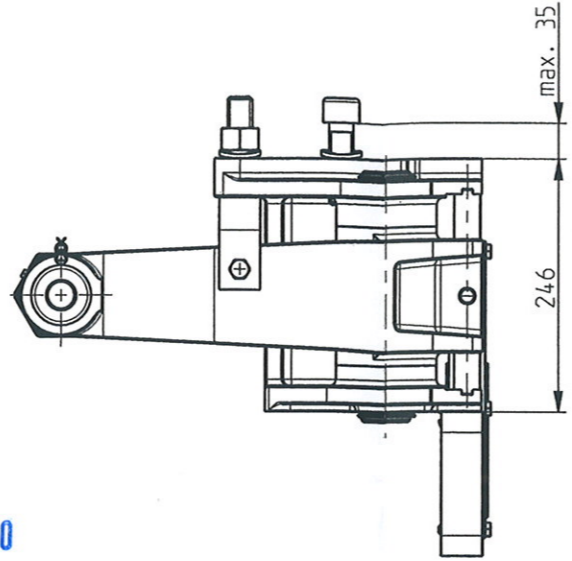
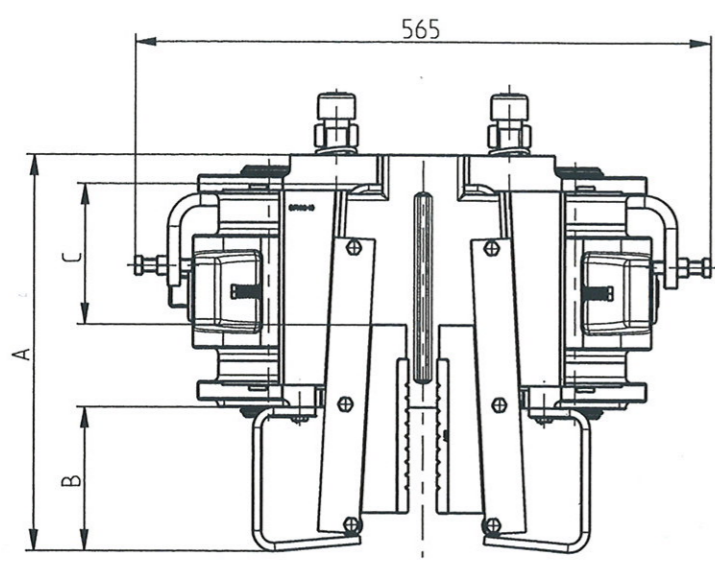

Machined guide rail according to ISO 7465 for surface, manufacturing and material quality

28. Okt. 2010
 - GEPRÜFT -
 TÜV SÜD Industrie Service GmbH
 Zentralbereich Fördertechnik-Sonderbauten
 Abteilung Aufzüge und Sicherheitsbauteile
 Westendstr. 199, D-80686 München
 Der Sachverständige

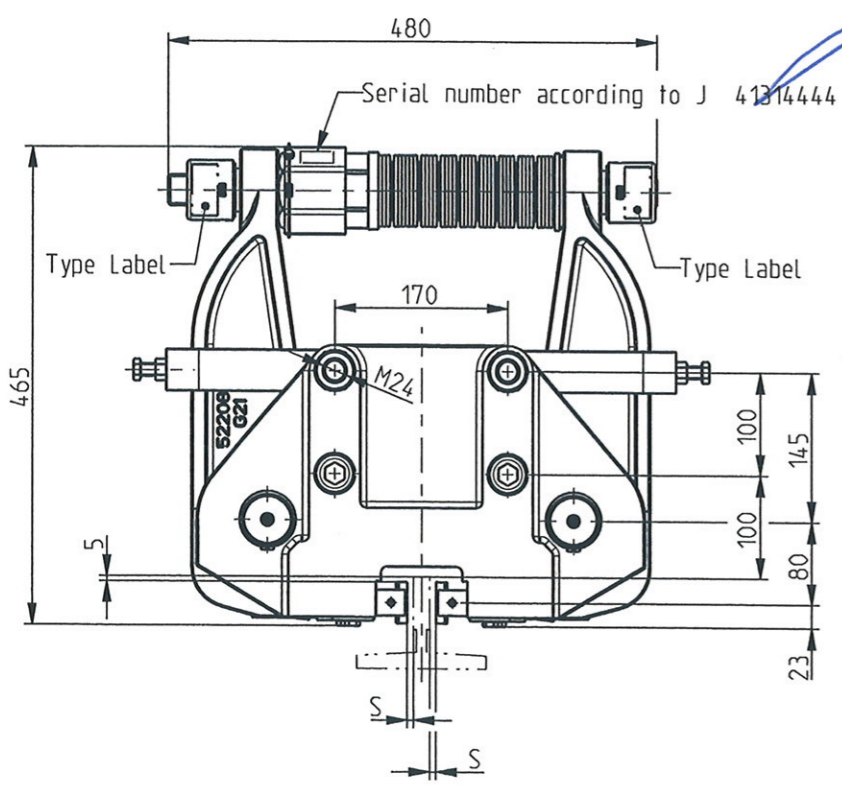

S= running clearance 3mm or 5mm

Bottom View

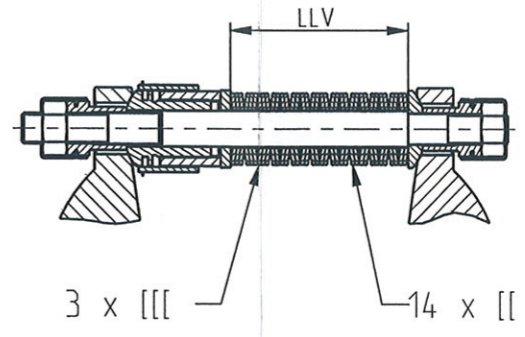
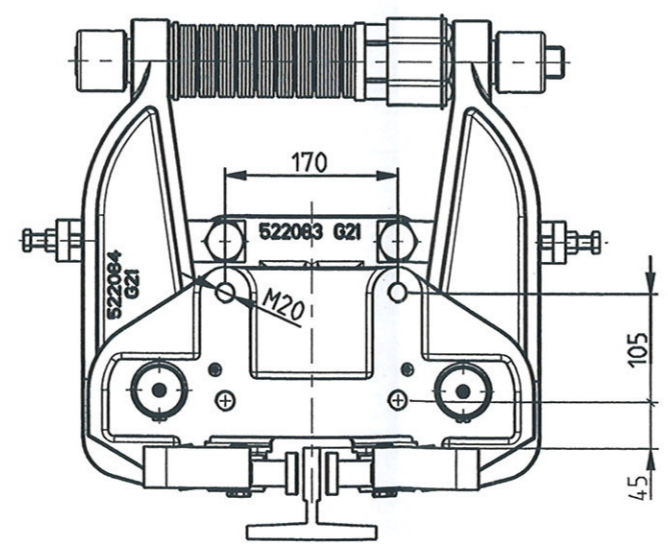

3	348.5	102.5	100
5	386.5	140.5	138
S	A	B	C

108259						110.029
Ident. No.	Semi finished product / raw material	Semi fin. Ident. No.	Item	Code surface	Heat treatment	Drwg / BOM / Model
Modification			Ae0	Draw Ver.	Related BOM	
KA No.			159072	5	Related BOM	
KA Date			2010-08-27	Model Ver.	Related BOM	
				16	Release Level	Released
Group: 01	Remark		Date	Name		
Dimensioned Drawing SA G 21			Scale	Replaces / Ae.	Prepared	2010-07-27 schmidm5
SA G 21			1:5		Reviewed	2010-08-02 fahrniro
			Page	Norms checked	Released	2010-08-02 fahrniro
			1/1		Released	2010-08-03 walkerw2
INVENTIO AG CH-6052 Hergiswil		Classification	Lead Office	M__103721		Lang. EN
		11540	EB3			
		Format A2				

This presentation is our intellectual property. Without our written consent, it shall neither be copied in any manner, nor used for manufacturing, nor communicated to third parties.
 Diese Darstellung ist unser geistiges Eigentum. Sie darf ohne unsere schriftliche Zustimmung weder irgendwie kopiert noch zur Anfertigung des Werkes gebraucht oder Dritten bekanntgegeben werden.
 Cet ouvrage est notre propriété intellectuelle. Sans notre autorisation écrite, il ne peut être ni copié d'une manière quelconque, ni être utilisé pour la fabrication, ni non plus être communiqué à des tiers.